



Delaware City

Community Park & Trail Master
Plan

Public Meeting

September 11, 2014

Consultant Team



Toole Recreation Planning



JOHNSON, MIRMIRAN & THOMPSON
Engineering A Brighter Future®

Master Plan

Agenda

1. Project overview
2. Site Analysis
 - Regional/Local Initiatives and Influences
 - DE City Comp Plan
 - Fort Dupont
 - Ecotourism Plan
 - Trail Town
3. Master Plan vision and Goals
4. Master Plan Physical Recommendations
5. Implementation Strategy
6. Comments and questions
7. Next Steps

Park Vision

*DE City Community Park
will be the best waterfront
park in the state.*

1. Diverse Activities and Uses

A park that provides numerous opportunities for group and individual activities, and experiences. A fun place that offers year-round, special, celebratory, useful, and relaxing spaces for residents and visitors.

2. Image and Comfort

Develop a park that is safe, clean, attractive, and charming. The park design should reflect a high standard of excellence

3. Complementary Land Uses

The parkland should be inviting and provide a seamless transition to the waterfront.

4. Increased Visual and Physical Access

The towns existing trail network provides critical pedestrian movements between the park, CBD, Battery Park, and beyond via the C&D trail. Limit opportunities exists for physical access to the canal within the corridor.

5. Economic Vitality

A park that is neighborly and welcoming. A place that is friendly, diverse, and exudes a strong sense of community.

6. Pedestrians First

A barrier free park that is convenient, walkable and bikeable. A convenient place connected to the CBD where pedestrians are not

Park Master Plan

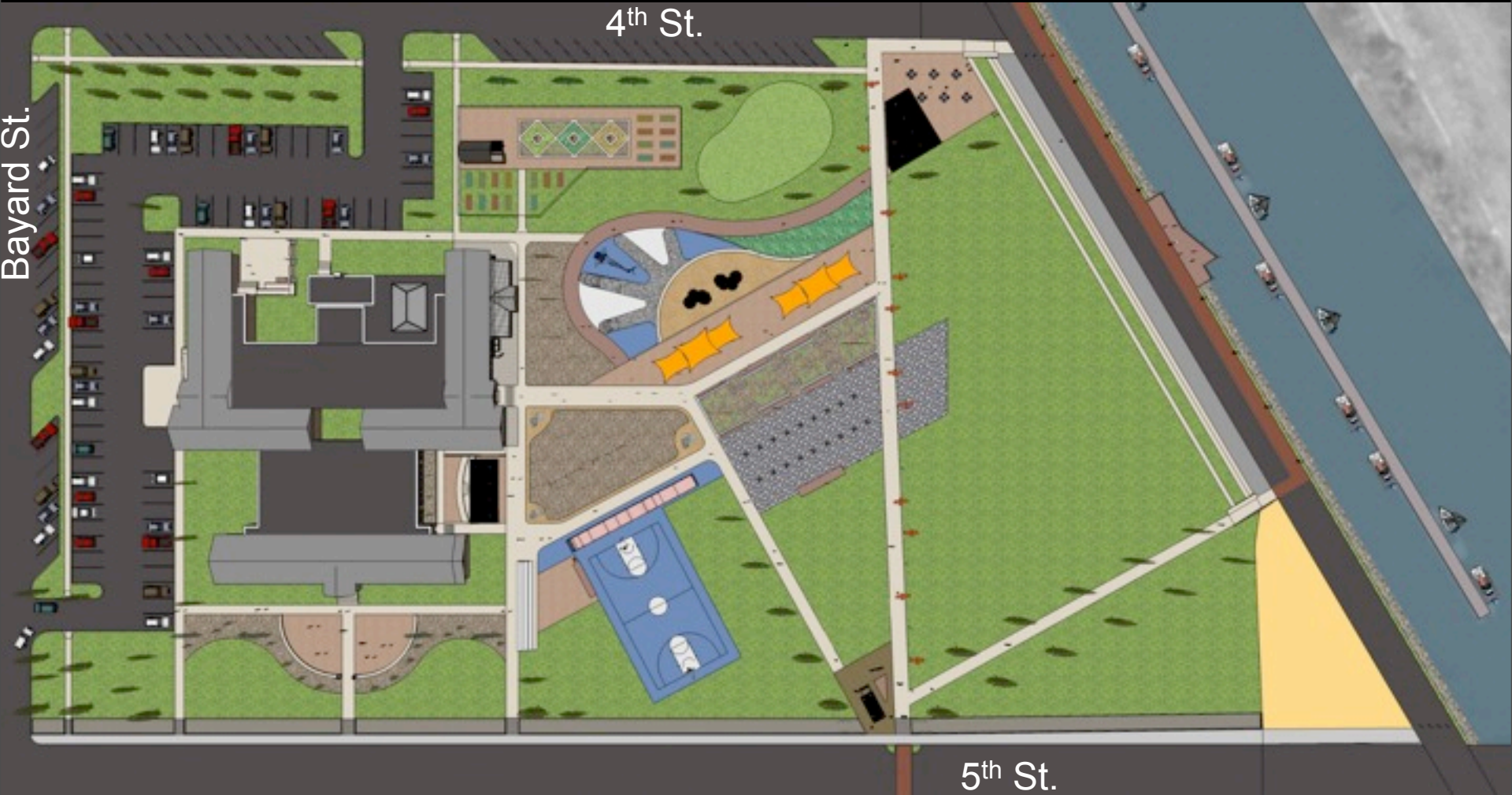

Gateway Information Kiosk



Gateway

Information Kiosk



Gateway Information Kiosk



Overlook Performance Area



Community Green



Sidewalk Cafe



Market (farmers/craft) Space



Splash Plaza



Entry Court



Public Art - Sculptures



Public Art - Mural



Eco - Education



Play Space



Play Space



Teen Area



Shade Sail Alley



Sunday, September 14, 2014

Mounded Lounge Area



Sunday, September 14, 2014

Community Garden



Sunday, September 14, 2014

Expanded Parking Areas





Parking Lot →

Trailhead →

Dragon Run Trail
0.89 mi. →

Interpretive Sign →

Promenade
0.76 mi. →

Dragon Run Trail to Park
0.61 mi. →

Interpretive Sign →

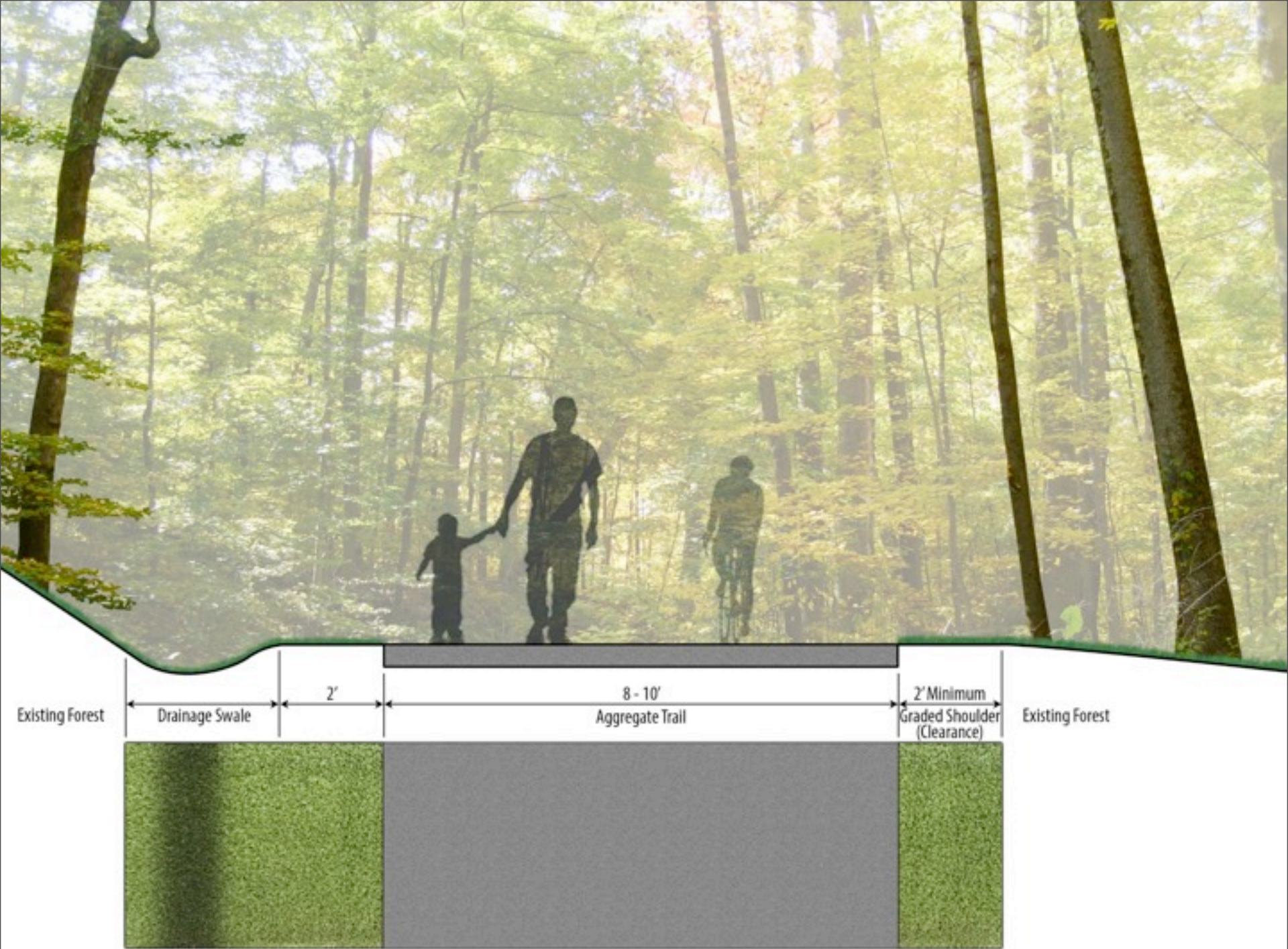

Town Gateway



Sunday, September 14, 2014

Campus image – traffic calming – “*Bike Friendly*” –statement

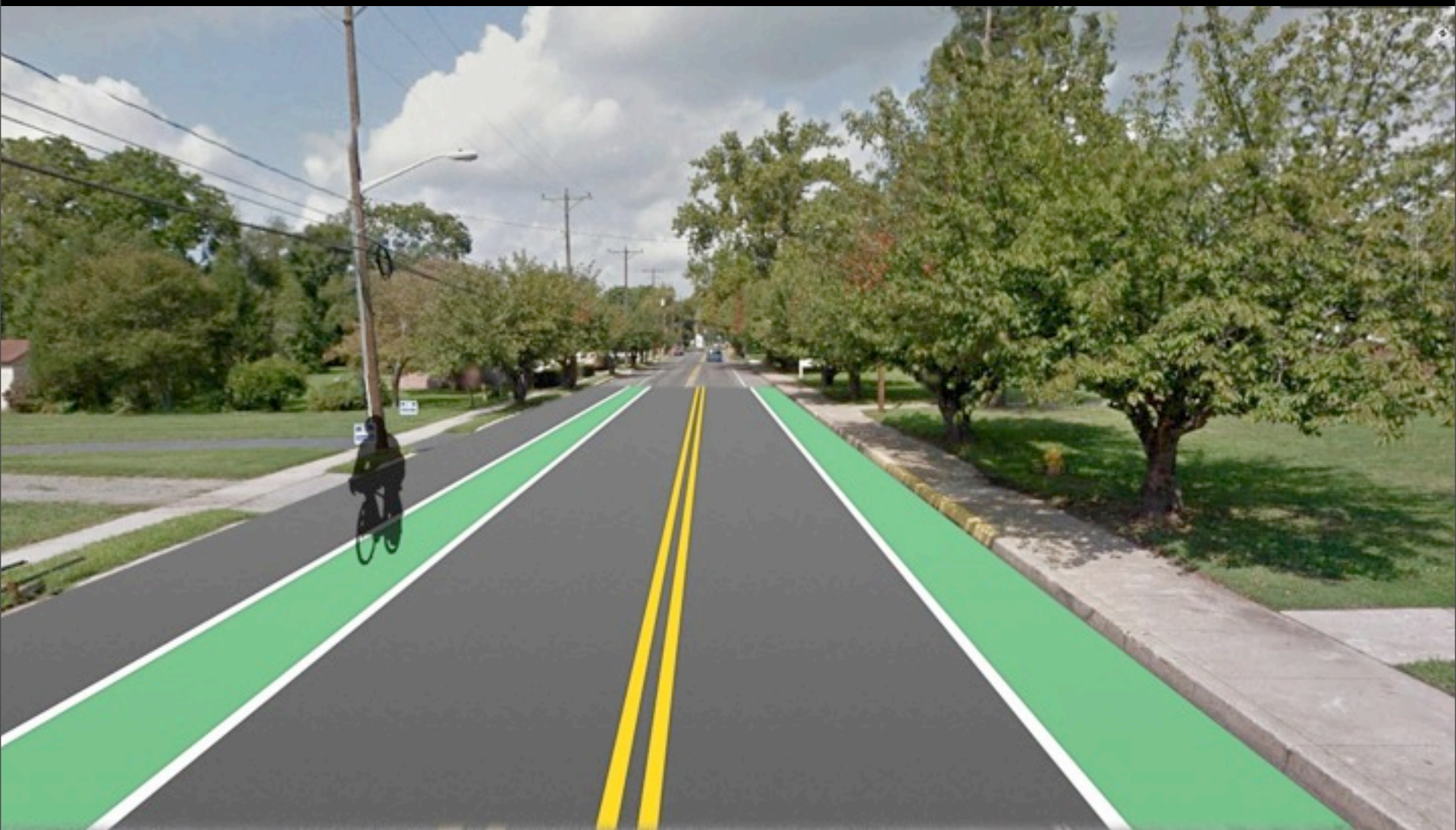

Sunday, September 14, 2014

DE City Library Building

*“Providing a sense of community: we work very closely with many agencies in our community that serve kids, teens, adults and seniors. **We try to coordinate services not compete.**”*

– Library services in the digital age, Pew Internet Project

The DE City Library's is a Community Recreation Center. It is a place where the community comes to learn, recreate, socialize, meet, do business, and educate. It is the social HUB of the community and will become the central jump point for local and community recreation.

Building Layout

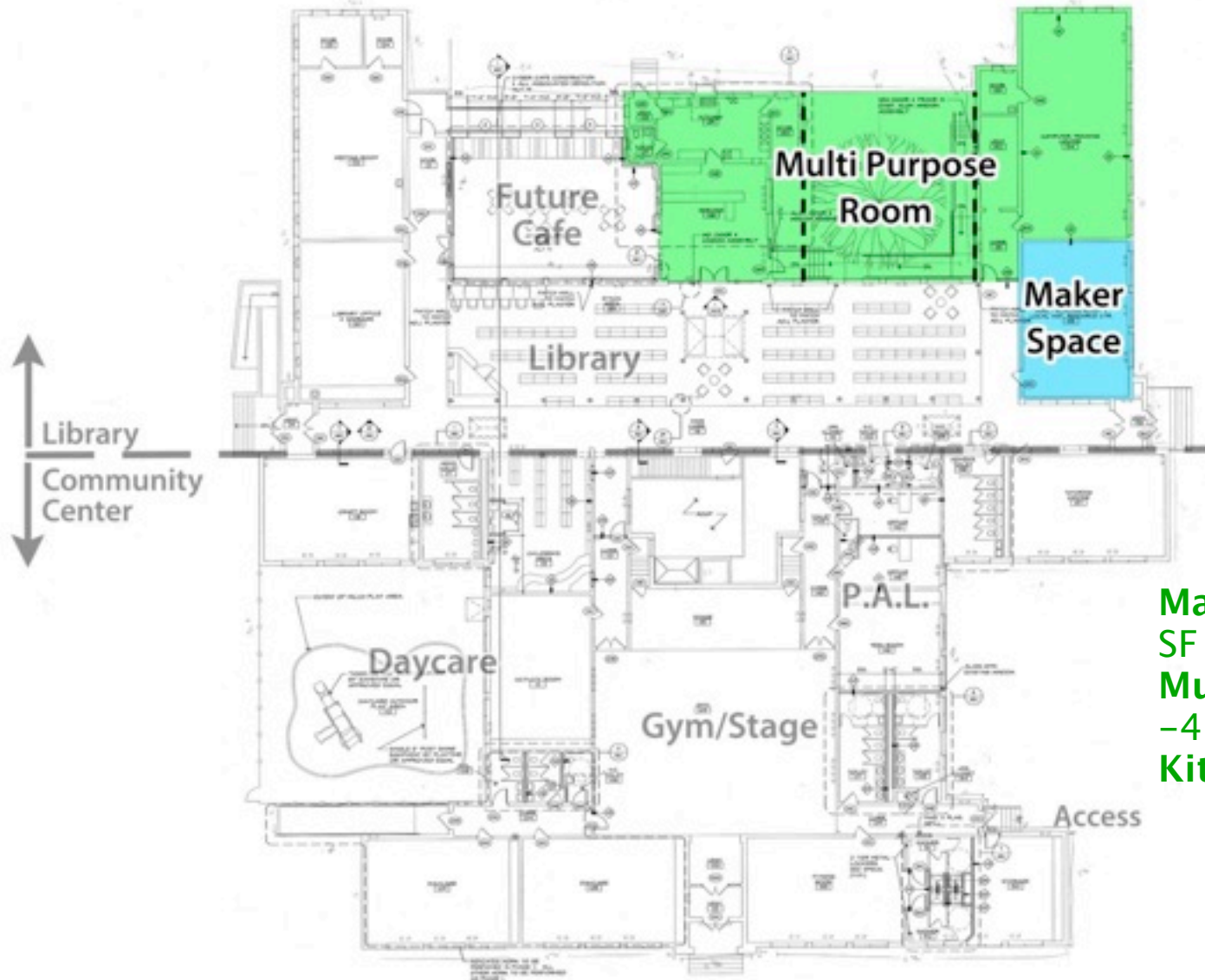

Maker Space - 1,000 SF
Multi Purpose Room - 4,000 SF
Kitchen - 1,500 SF

Multipurpose Space



Sunday, September 14, 2014

Multipurpose Space



Sunday, September 14, 2014



What's a Makerspace?

Sometimes also referred to as hackerspaces, hackspaces, and fablabs are creative, DIY spaces where people can gather to create, invent, and learn. In libraries they often have 3D printers, software, electronics, craft and hardware supplies and tools, and more.



To describe them simply, makerspaces are community centers with tools.

Maker Space



Secondary Library Entrance



Park/Community Center Programming



Protecting open space, connecting children to nature, and engaging communities in conservation practices.



Leading the nation to improved health and wellness through parks and recreation.



Ensuring all people have access to the benefits of local parks and recreation



Economic Driver: Events:

- Community Center
- Trail Town
- Outdoor venues

Reunion or Wedding Example

- Catering
- Rehearsal Hall
- DJ
- Florist
- Salon
- Photographer
- Party Planner
- Church
- Dress shop/Tux Rental
- Printer
- Overnight accommodations
- Brewery/Liquor Store

Park

Goals

The park serves as a gateway and central hub that reinforces the communities identity and supports and reflects the significant intrinsic qualities of Delaware City and the region.

1. Identify Delaware City as a Trail Town
2. Designate the Park as a Trailhead
 - Welcome travelers to the Town
 - Make visitors aware of local attraction and amenities
 - Provides a respite that informs travelers and re-energizes
 - Encourages and promotes ecotourism
3. Serves as a vital link to old and new Delaware City
4. Provides an attractive feature that promotes community pride
5. Accommodate programming opportunities that align with local initiatives
6. Maximizes Community Building use for residents and visitors
7. Provide multi-functional spaces for local, special event, and visitor use
8. Maximize daily use opportunities for residents

Destination

Park

Goals

The park serves as a gateway and central hub that reinforces the communities identity and supports and reflects the significant intrinsic qualities of Delaware City and the region.

1. Identify Delaware City as a Trail Town
2. Designate the Park as a Trailhead
 - Welcome travelers to the Town
 - Make visitors aware of local attraction and amenities
 - Provides a respite that informs travelers and re-energizes
 - Encourages and promotes ecotourism
3. Serves as a vital link to old and new Delaware City
4. Provides an attractive feature that promotes community pride
5. Accommodate programming opportunities that align with local initiatives
6. Maximizes Community Building use for residents and visitors
7. Provide multi-functional spaces for local, special event, and visitor use
8. Maximize daily use opportunities for residents

Destination

Ecologically significant

Park

Goals

The park serves as a gateway and central hub that reinforces the communities identity and supports and reflects the significant intrinsic qualities of Delaware City and the region.

1. Identify Delaware City as a Trail Town
2. Designate the Park as a Trailhead
 - Welcome travelers to the Town
 - Make visitors aware of local attraction and amenities
 - Provides a respite that informs travelers and re-energizes
 - Encourages and promotes ecotourism
3. Serves as a vital link to old and new Delaware City
4. Provides an attractive feature that promotes community pride
5. Accommodate programming opportunities that align with local initiatives
6. Maximizes Community Building use for residents and visitors
7. Provide multi-functional spaces for local, special event, and visitor use
8. Maximize daily use opportunities for residents

Destination

Ecologically significant

Linear

Park

Goals

The park serves as a gateway and central hub that reinforces the communities identity and supports and reflects the significant intrinsic qualities of Delaware City and the region.

1. Identify Delaware City as a Trail Town
2. Designate the Park as a Trailhead
 - Welcome travelers to the Town
 - Make visitors aware of local attraction and amenities
 - Provides a respite that informs travelers and re-energizes
 - Encourages and promotes ecotourism
3. Serves as a vital link to old and new Delaware City
4. Provides an attractive feature that promotes community pride
5. Accommodate programming opportunities that align with local initiatives
6. Maximizes Community Building use for residents and visitors
7. Provide multi-functional spaces for local, special event, and visitor use
8. Maximize daily use opportunities for residents

Destination

Ecologically significant

Linear

Accessible

Park

Goals

The park serves as a gateway and central hub that reinforces the communities identity and supports and reflects the significant intrinsic qualities of Delaware City and the region.

1. Identify Delaware City as a Trail Town
2. Designate the Park as a Trailhead
 - Welcome travelers to the Town
 - Make visitors aware of local attraction and amenities
 - Provides a respite that informs travelers and re-energizes
 - Encourages and promotes ecotourism
3. Serves as a vital link to old and new Delaware City
4. Provides an attractive feature that promotes community pride
5. Accommodate programming opportunities that align with local initiatives
6. Maximizes Community Building use for residents and visitors
7. Provide multi-functional spaces for local, special event, and visitor use
8. Maximize daily use opportunities for residents

Destination

Ecologically significant

Linear

Accessible

Waterfront

Park

Goals

The park serves as a gateway and central hub that reinforces the communities identity and supports and reflects the significant intrinsic qualities of Delaware City and the region.

1. Identify Delaware City as a Trail Town
2. Designate the Park as a Trailhead
 - Welcome travelers to the Town
 - Make visitors aware of local attraction and amenities
 - Provides a respite that informs travelers and re-energizes
 - Encourages and promotes ecotourism
3. Serves as a vital link to old and new Delaware City
4. Provides an attractive feature that promotes community pride
5. Accommodate programming opportunities that align with local initiatives
6. Maximizes Community Building use for residents and visitors
7. Provide multi-functional spaces for local, special event, and visitor use
8. Maximize daily use opportunities for residents

Destination

Ecologically significant

Linear

Accessible

Waterfront

Attractions

Park

Goals

The park serves as a gateway and central hub that reinforces the communities identity and supports and reflects the significant intrinsic qualities of Delaware City and the region.

1. Identify Delaware City as a Trail Town
2. Designate the Park as a Trailhead
 - Welcome travelers to the Town
 - Make visitors aware of local attraction and amenities
 - Provides a respite that informs travelers and re-energizes
 - Encourages and promotes ecotourism
3. Serves as a vital link to old and new Delaware City
4. Provides an attractive feature that promotes community pride
5. Accommodate programming opportunities that align with local initiatives
6. Maximizes Community Building use for residents and visitors
7. Provide multi-functional spaces for local, special event, and visitor use
8. Maximize daily use opportunities for residents

Destination

Ecologically significant

Linear

Accessible

Waterfront

Attractions

Recreation

Park

Goals

The park serves as a gateway and central hub that reinforces the communities identity and supports and reflects the significant intrinsic qualities of Delaware City and the region.

1. Identify Delaware City as a Trail Town
2. Designate the Park as a Trailhead
 - Welcome travelers to the Town
 - Make visitors aware of local attraction and amenities
 - Provides a respite that informs travelers and re-energizes
 - Encourages and promotes ecotourism
3. Serves as a vital link to old and new Delaware City
4. Provides an attractive feature that promotes community pride
5. Accommodate programming opportunities that align with local initiatives
6. Maximizes Community Building use for residents and visitors
7. Provide multi-functional spaces for local, special event, and visitor use
8. Maximize daily use opportunities for residents

Destination

Ecologically significant

Linear

Accessible

Waterfront

Attractions

Recreation

Economic base

Park

Goals

The park serves as a gateway and central hub that reinforces the communities identity and supports and reflects the significant intrinsic qualities of Delaware City and the region.

1. Identify Delaware City as a Trail Town
2. Designate the Park as a Trailhead
 - Welcome travelers to the Town
 - Make visitors aware of local attraction and amenities
 - Provides a respite that informs travelers and re-energizes
 - Encourages and promotes ecotourism
3. Serves as a vital link to old and new Delaware City
4. Provides an attractive feature that promotes community pride
5. Accommodate programming opportunities that align with local initiatives
6. Maximizes Community Building use for residents and visitors
7. Provide multi-functional spaces for local, special event, and visitor use
8. Maximize daily use opportunities for residents

Destination

Ecologically significant

Linear

Accessible

Waterfront

Attactions

Recreation

Economic base

Connected

Park

Goals

The park serves as a gateway and central hub that reinforces the communities identity and supports and reflects the significant intrinsic qualities of Delaware City and the region.

1. Identify Delaware City as a Trail Town
2. Designate the Park as a Trailhead
 - Welcome travelers to the Town
 - Make visitors aware of local attraction and amenities
 - Provides a respite that informs travelers and re-energizes
 - Encourages and promotes ecotourism
3. Serves as a vital link to old and new Delaware City
4. Provides an attractive feature that promotes community pride
5. Accommodate programming opportunities that align with local initiatives
6. Maximizes Community Building use for residents and visitors
7. Provide multi-functional spaces for local, special event, and visitor use
8. Maximize daily use opportunities for residents

Destination

Ecologically significant

Linear

Accessible

Waterfront

Attractions

Recreation

Economic base

Connected

Iconic

Park

Goals

The park serves as a gateway and central hub that reinforces the communities identity and supports and reflects the significant intrinsic qualities of Delaware City and the region.

1. Identify Delaware City as a Trail Town
2. Designate the Park as a Trailhead
 - Welcome travelers to the Town
 - Make visitors aware of local attraction and amenities
 - Provides a respite that informs travelers and re-energizes
 - Encourages and promotes ecotourism
3. Serves as a vital link to old and new Delaware City
4. Provides an attractive feature that promotes community pride
5. Accommodate programming opportunities that align with local initiatives
6. Maximizes Community Building use for residents and visitors
7. Provide multi-functional spaces for local, special event, and visitor use
8. Maximize daily use opportunities for residents

Destination

Ecologically significant

Linear

Accessible

Waterfront

Attractions

Recreation

Economic base

Connected

Iconic

Trail town

Park

Goals

The park serves as a gateway and central hub that reinforces the communities identity and supports and reflects the significant intrinsic qualities of Delaware City and the region.

1. Identify Delaware City as a Trail Town
2. Designate the Park as a Trailhead
 - Welcome travelers to the Town
 - Make visitors aware of local attraction and amenities
 - Provides a respite that informs travelers and re-energizes
 - Encourages and promotes ecotourism
3. Serves as a vital link to old and new Delaware City
4. Provides an attractive feature that promotes community pride
5. Accommodate programming opportunities that align with local initiatives
6. Maximizes Community Building use for residents and visitors
7. Provide multi-functional spaces for local, special event, and visitor use
8. Maximize daily use opportunities for residents

Destination

Ecologically significant

Linear

Accessible

Waterfront

Attactions

Recreation

Economic base

Connected

Iconic

Trail town

Ynot here!

Implementation Plan



Meeting Ground Rules

Comments & Questions

1. Please take a few minutes and write down your specific concerns and or ideas regarding development of the park.
2. You will only be able to share or convey one thought per turn to ensure that everyone gets a chance to speak.
3. Naturally, everyone will not agree with all comments, issues, concerns or ideas raised. This is not the place or forum to debate specific items.
4. Everyone will have a chance to speak; please remain quiet while someone else is talking.
5. There is no need to repeat an idea if it has already been mentioned.

Next Steps

- Finalize the master plan and complete the plan narrative
- Provide the final plan and narrative to the study committee for review
- Address study committee comments
- Deliver final plan to Town Council

Contact :
Andy Mears, PLA
717.741-6269
amears@jmt.com